

YASKAWA

ArcWorld Mini

Delivering a flexible, space saving and cost-effective option to integrate robotics into your welding processes.





Key benefits

- Easy to install and operate.
- Easy to relocate.
- Small footprint (2.25 sq.m).

Ideal for replacing or supplementing manual welding, e.g. for pre assembly prior to welding in a larger robot cell. With our Mini series it is possible to double the output, with half of the preparation time. Complete with robot and controller the ArcWorld Mini RS with its revolving door and table has plenty to offer on a very small shape.

Scope of delivery

- Platform and casing with blue polycarbonate glare shield protection.
- MOTOMAN-GP7 robot with YRC1000 controller.
- Manually operated rotating turntable.
- Complete welding package from Esab, Fronius or Kemppi.
- Welding Wizard for creating robot jobs.
- Start/stop button panel.
- Fume extraction hood.
- CE-marking.

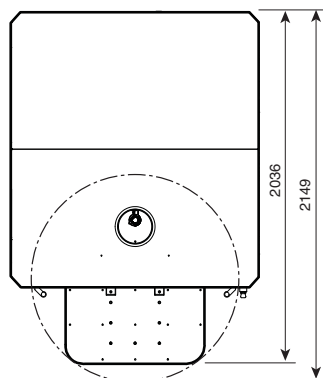
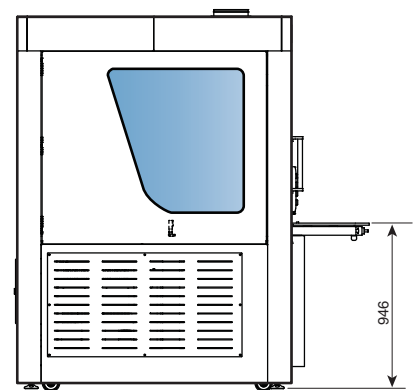
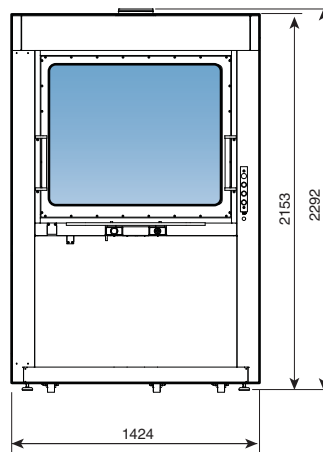

All dimensions are for reference only.

Request detailed drawings for design/engineering requirements!

ArcWorld Mini RS

Dimensions	1424x2036x2192 mm
Weight	895 kg
Robot	MOTOMAN-GP7
Controller	YRC1000

Controlled by
YRC1000



Key benefits

- Easy to install and operate.
- Easy to relocate.
- Small footprint (1.3 sq.m).

Ideal for replacing or supplementing manual welding, e.g. for pre assembly prior to welding in a larger robot cell. With our Mini series it is possible to double the output, with half of the preparation time. Complete with robot and controller the ArcWorld Mini HS with its hinged door opening has plenty to offer on a very small shape.

Scope of delivery

- Platform and casing with polycarbonate glare shield protection.
- MOTOMAN-GP7 robot with YRC1000 controller.
- Complete welding package from Esab, Fronius or Kemppi.
- Welding Wizard for creating robot jobs.
- Start/stop button panel.
- Fume extraction hood.
- CE-marking.

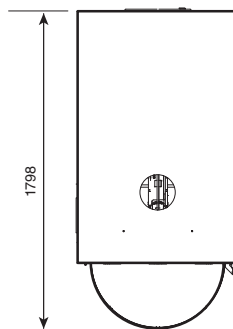
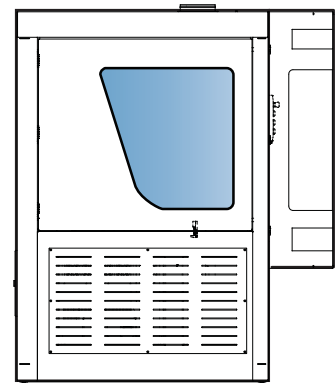
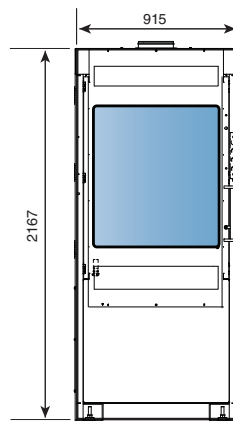

All dimensions are for reference only.

Request detailed drawings for design/engineering requirements!

ArcWorld Mini HS

Dimensions	1798x915x2197 mm
Weight	690 kg
Robot	MOTOMAN-GP7
Controller	YRC1000

Controlled by
YRC1000

ArcWorld

LESS SPACE | MORE OUTPUT

ArcWorld

LESS SPACE | MORE OUTPUT

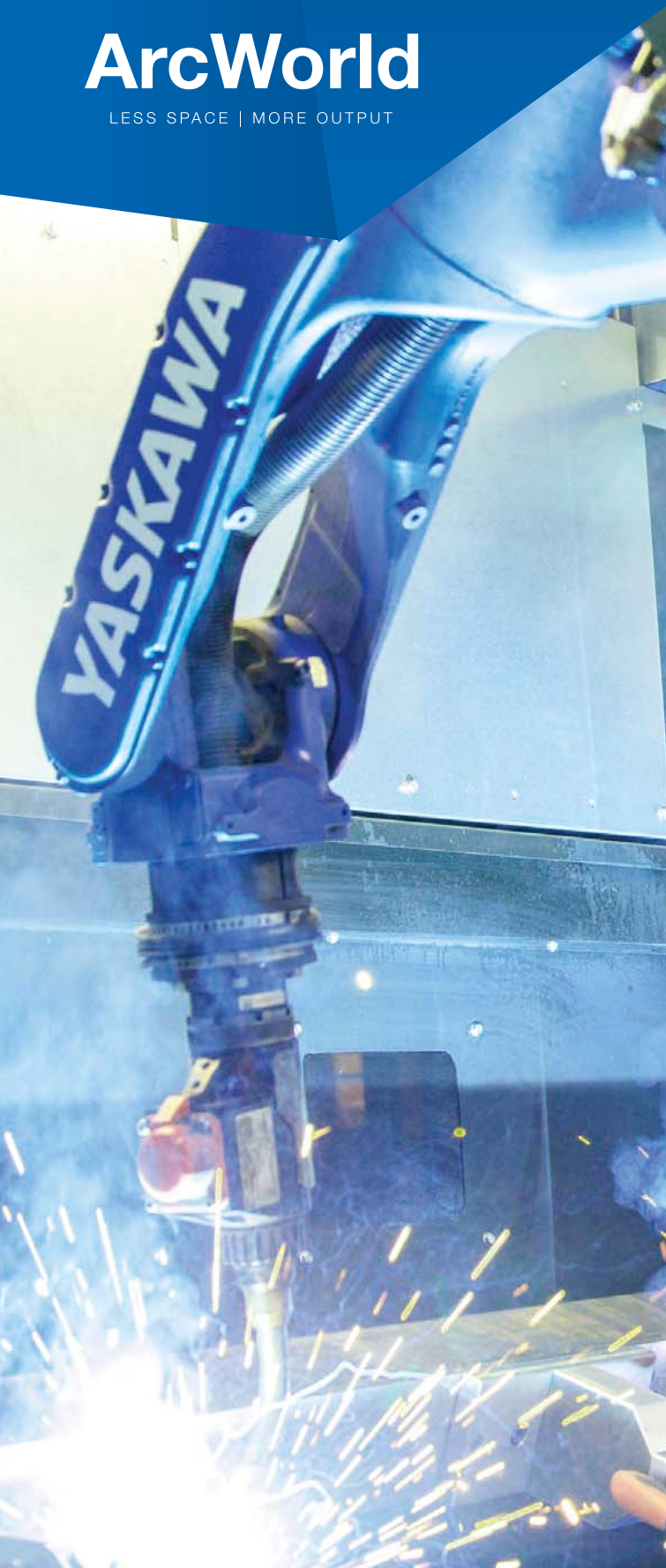

Industrial robot

MOTOMAN-GP7 with a 7 kg payload capacity and an easy-to-clean finish.



It is equipped with a selection of advanced programming functions to maximize weld quality and robot speed.

Options

- Wheel kit.
- Torch cleaning station.
- Fixture hole plates and fixture clamps.
- Colours by customer choice.
- Welding kit.

Welding kit

Each welding kit contains a welding power source, cable bundle, wire feeder and welding torch.

The power sources are:

- **Kemppi** A7 Mig Welder 350.
- **Esab** Aristo Mig 400i Pulse.
- **Fronius** TPS 320i.

The ArcWorld family

Our complete range of ArcWorld series can be found at: www.arcworld.eu.



YASKAWA



YASKAWA Nordic AB
PO Box 504
SE-385 25 Torsås, SWEDEN

Phone +46 480 41 78 00
info.se@yaskawa.eu.com
www.yaskawa.eu.com